



SCAN ME!

Onboarding Perspectives: What EHRs wish they could say to IIS & vice versa

Damon Ferlazzo, MPA | AIRA IIP | Business Analyst & Technical Writer
Melissa McClung, MSPH | AIRA IIP | Immunization Integration Program Director

Discussion Overview

- Introduction to the IIP (5 min.)
- Methods & Caveats (2 min.)
- Perspectives on...
 - General Onboarding (10 min.)
 - Discovery & Planning (10 min.)
 - Development & Testing (10 min.)
 - Go-live & Beyond (10 min.)
- Suggestions & Resources (3 min.)



EHRs and IIS: Better Together

- Connectivity
 - Access to a patient's full immunization history and forecast of dose due
- Collaboration
 - Shared data results in complete and accurate information
- Visibility
 - Better sight into the history and forecasting future needs for providers
 - Access to data: consumers/patients, schools, public health programs



Immunization Integration Program (IIP) Overview

- HIMSS initiative
- Improve interoperability between EHRs and IIS
- Provide timely access to complete and accurate immunization data
 - Improve data use (clinical decision-making) and population health
 - Lower VPD incidence
- Strategies:
 1. Collaborative
 2. Testing & Recognition

Project Partners



AIRA
AMERICAN IMMUNIZATION
REGISTRY ASSOCIATION

Volunteer SMEs



IIS
Vendors



IIS



Clinicians



EHRs



Health IT



Associations

Methods & Caveats for EHR Perspectives

- EHR vendors and individuals will not be identified by name to promote candid and open communication
- Based upon:
 - Common pain points expressed during IIP Collaborative efforts
 - Requested comments via email
 - One-hour interviews with 5 EHR vendors

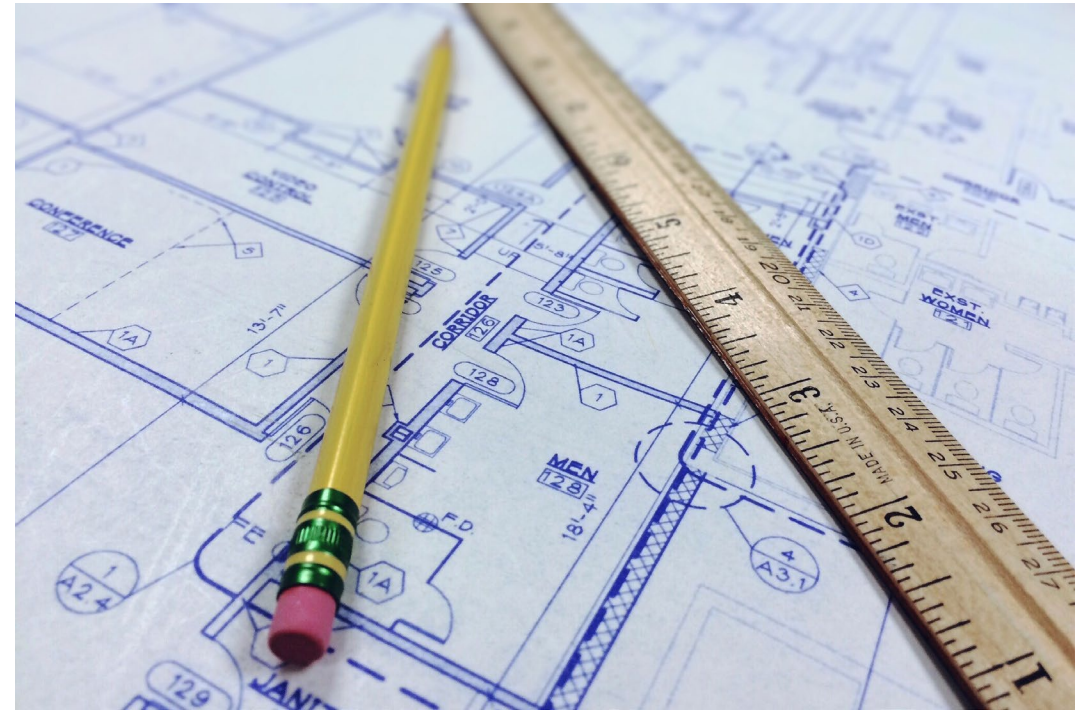



Discussion



SCAN ME!



Discussion Format

- Key points from the EHR perspective
- Audience poll questions
- Audience discusses responses or provides additional perspectives



SCAN ME!



Menti Instructions

- Scan the QR code with your mobile device

SCAN ME!



Or

- Use your favorite device and go to Menti.com and enter the 8-digit code from the top

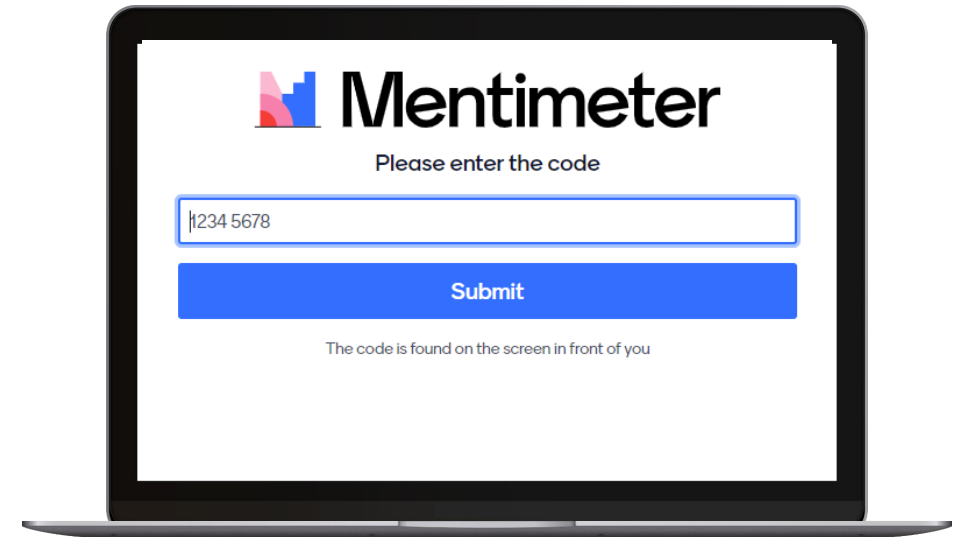

Want to answer “other”?

1. Click “Open Q&A”

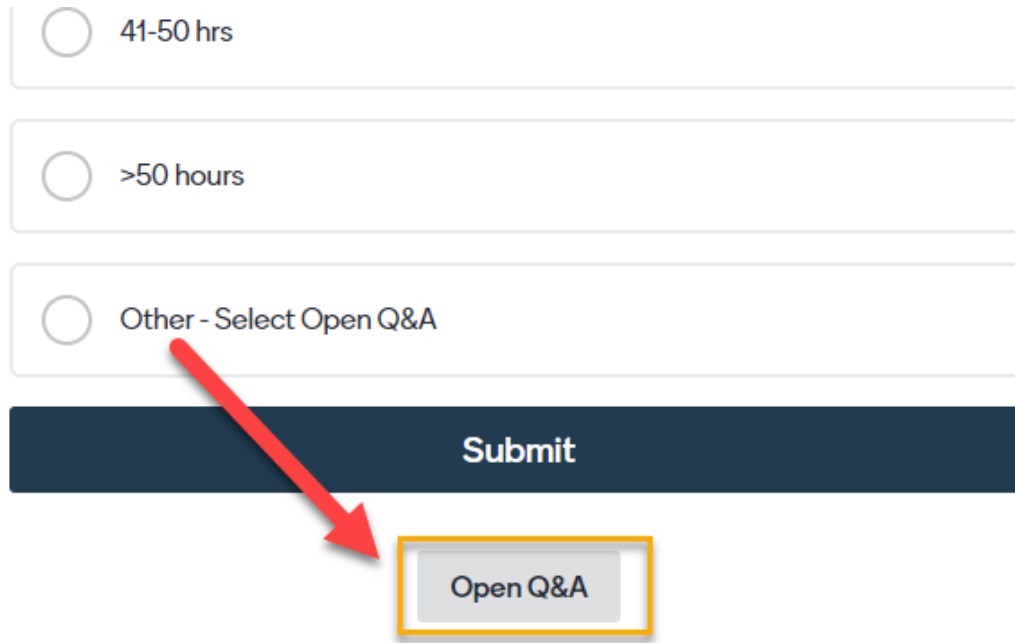

☐ 41-50 hrs

☐ >50 hours

☐ Other - Select Open Q&A

Submit

Open Q&A

2. Enter your “other” response, and click “Submit”

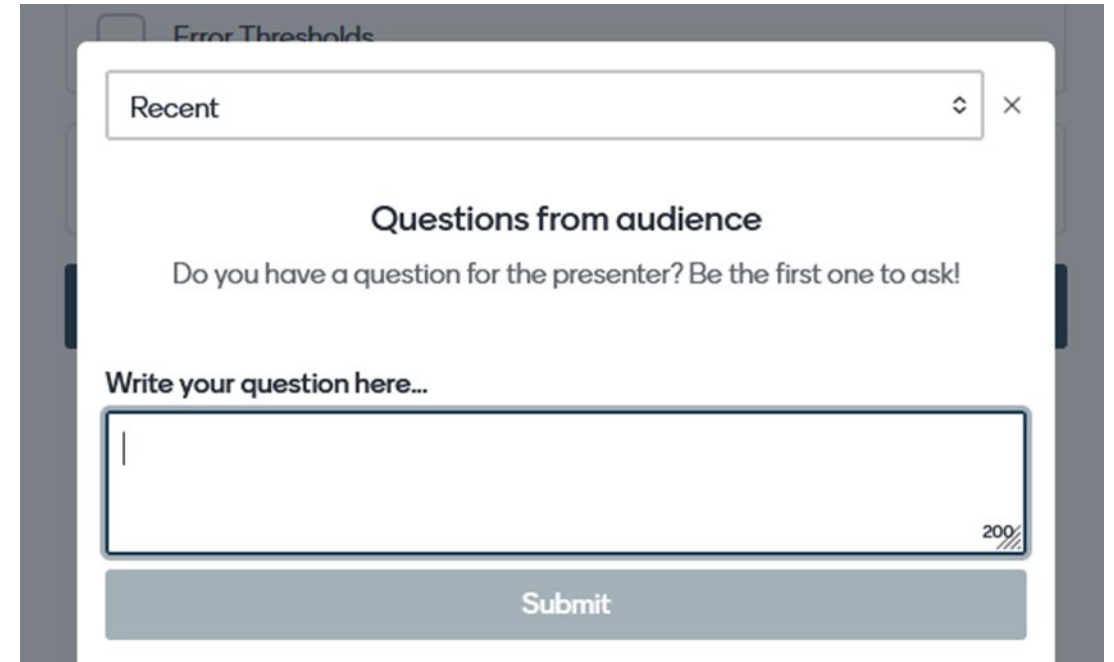

Error Thresholds

Recent

Questions from audience

Do you have a question for the presenter? Be the first one to ask!

Write your question here...

200

Submit

What perspective do you offer?

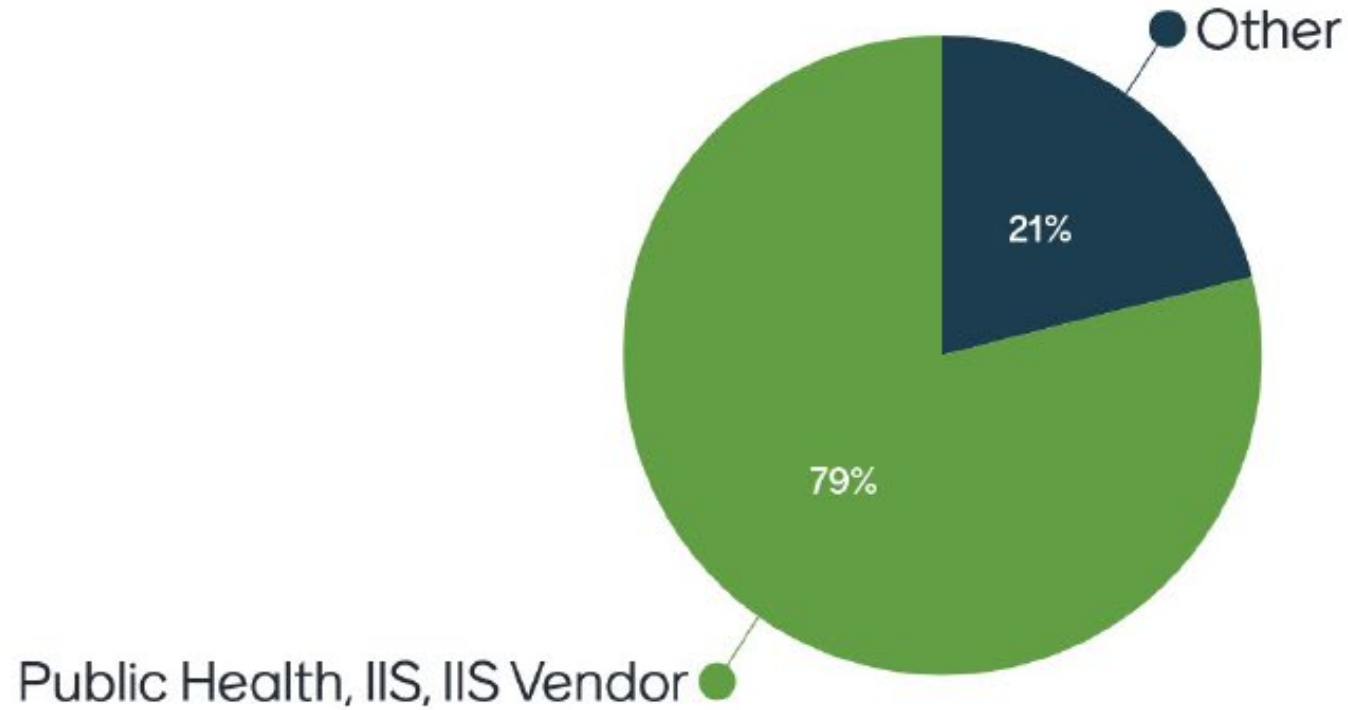

General



- EHR vendors employ humans who:
 - Want to do a good job
 - Like pleasing customers
 - Solve problems
 - Understand the value of data quality and immunizations
 - Do not like complexity or bureaucracy
 - Avoid unnecessary repetition

What words come to mind when you hear "onboarding"?

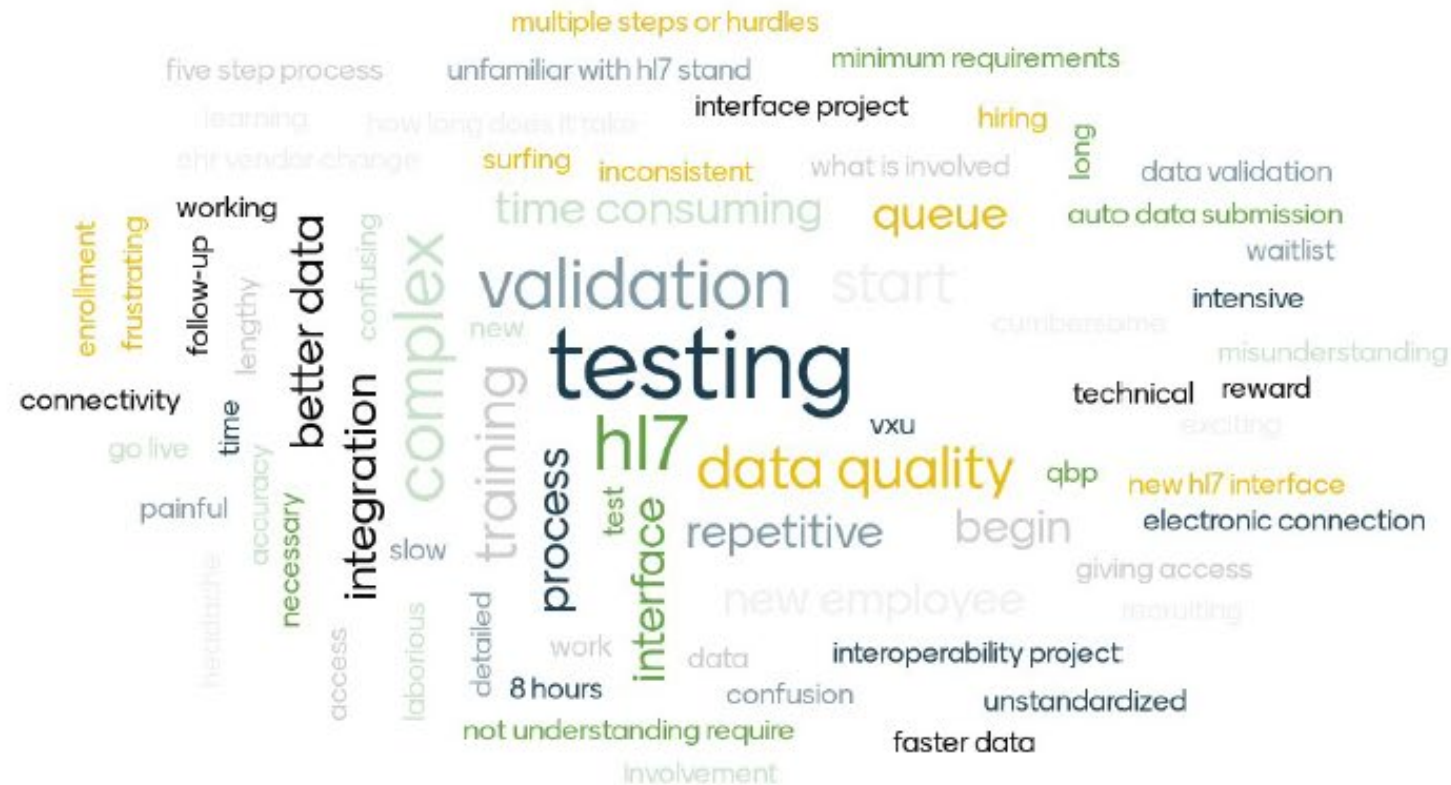



EHR



Discovery & Planning

- What are typical costs for a new interface?
 - Wrapped into other fees
 - Incentive programs \$ < true costs
 - Estimates from 1 vendor:
 - Minimum 8 hours
 - COVID requirements = 320 hours
 - Average 30-90 days (Registration - Production)



[This Photo](#) by Unknown Author is licensed under [CC BY-SA-NC](#)

Discovery & Planning

- How long should onboarding take?

- Ideal: < 1 week
- Average: 30-90 days
- Quickest: 3 days
- Longest: 1-2 years



[This Photo](#) by Unknown Author is licensed under [CC BY-SA-NC](#)



Discovery & Planning

- Clinical staff participation
 - Usually only a couple of people
 - Typically, a vaccine manager
 - Physicians are usually not involved unless it's a small practice
- Training
 - Resources vary for EHR customers
 - Few reported dedicated IIS training resources for clinical staff for electronic interfaces
 - Done by clinic/health system and IIS

Discovery & Planning



- Information
 - More is better
 - Upfront & comprehensive
 - Uniqueness / Delta Guide
- Are we there yet?
 - Setting clear expectations and project timelines



On average, how much IIS staff time is spent setting up a single interface?

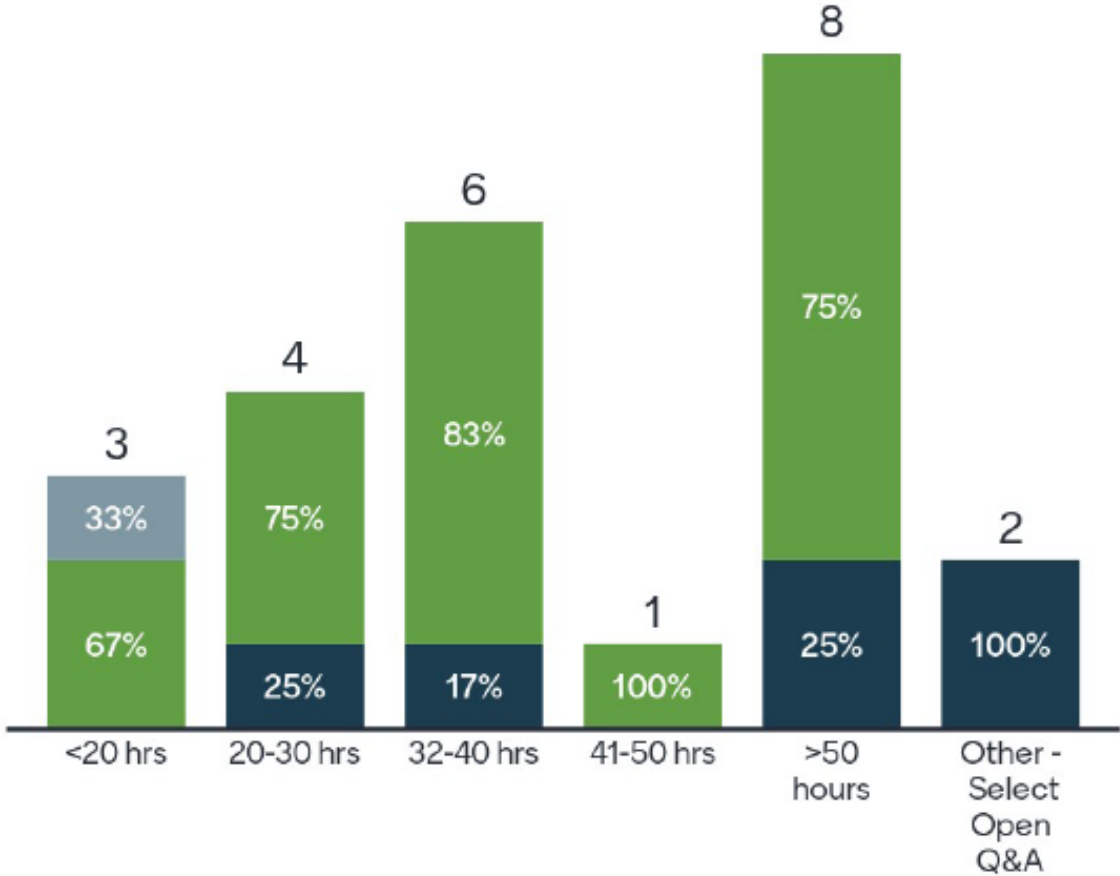

What perspective do you offer?

- Other
- Public Health, IIS, IIS Vendor
- Unknown

2-4 Weeks

How is onboarding information shared with providers/EHRs?



What perspective do you offer?

- Other
- Public Health, IIS, IIS Vendor
- Unknown

Both email and phone call.

What onboarding materials are provided?

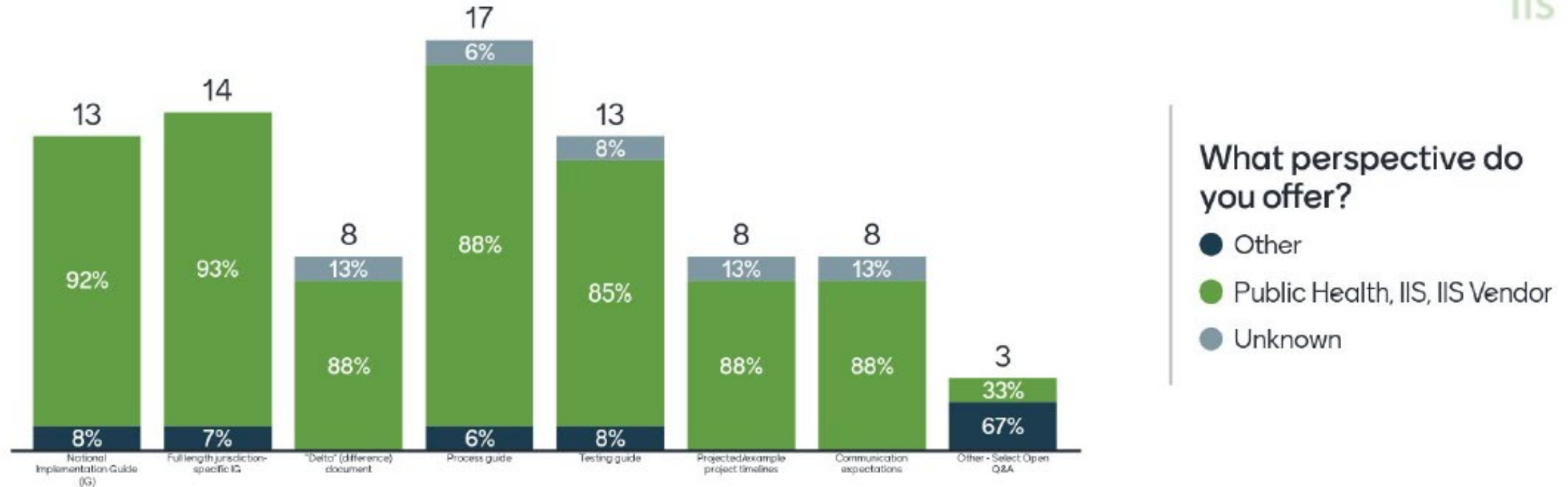

1. Onboarding/SOAP/Implementation guides on website.
2. RedCap Survey Tool
3. MOU and other required on boarding documents

Discovery & Planning





Development & Testing

- The shorter, the better
- Steer away from scenarios and instead evaluate EHR production data
- Automate testing
 - Provide self-service tools
 - Provide the same person for support
 - On-demand or regular reports without human intervention
- Empower your team with knowledge and decision-making abilities & minimize handoffs to other team members

What tool(s) do you make available for providers/EHRs?

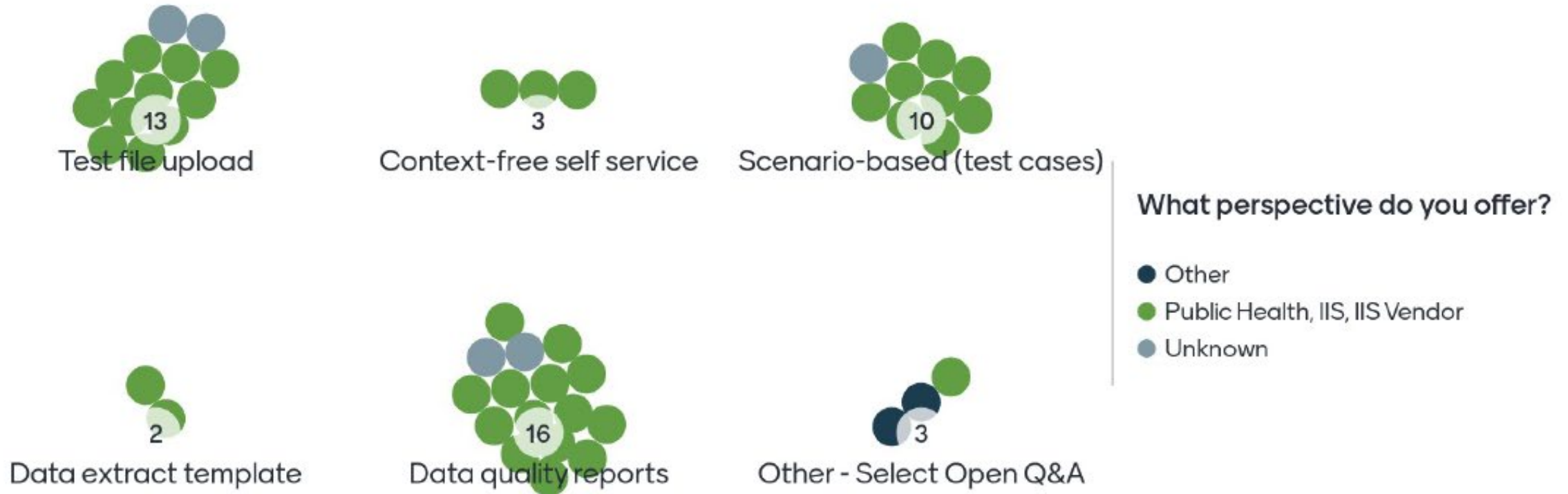

1. NIST x2
2. data quality feedback (bulleted, not necessarily in a report format)

When working with your IIS, how quickly could an EHR/provider go through testing?

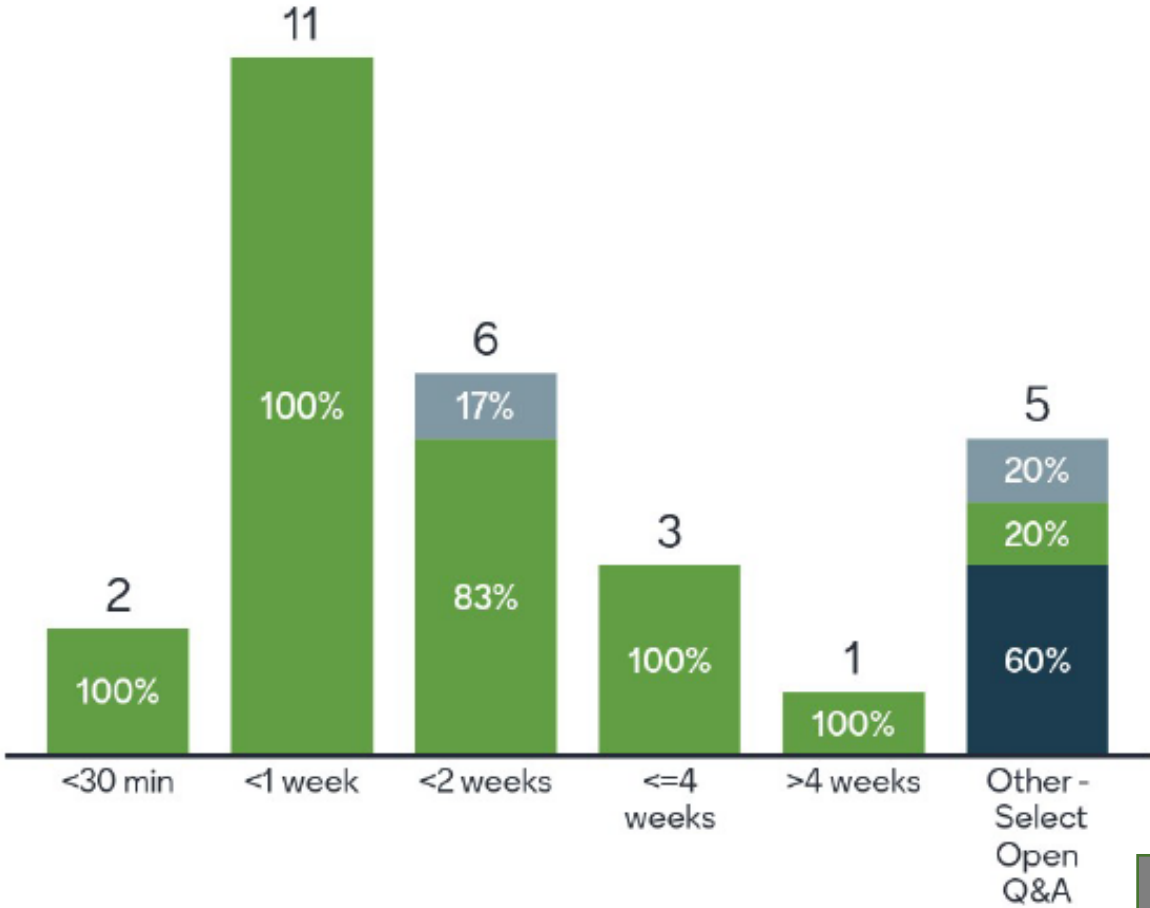

What perspective do you offer?

- Other
- Public Health, IIS, IIS Vendor
- Unknown

1. Depends on engagement
2. Depends on how much training the practice has with the IIS requirements)

Development & Testing



Go-live & Beyond



- Is someone monitoring ACK data after go-live?
 - Varying level of resources on provider side
 - Solutions:
 - Consider aggregate “E” level (severity=error) ACK reports
 - Consider DQA reports with action steps



Go-live & Beyond

- What are clients' (providers) attitudes towards query-response interfaces?
 - In general, very positive and useful
 - Inexact/multiple matches add to provider burden and can impact trust in IIS provided data (duplicates / bad matches)

What criteria do you use to determine production readiness?



1. Why don't the EHR vendors work with the IIS to get their providers set up instead of working with the individual providers?

1
Time

3
Volume

24
Error Thresholds

5
Other - Select Open Q&A

What perspective do you offer?

- Other
- Public Health, IIS, IIS Vendor
- Unknown

1. Quality of data
2. Meeting of all test case scenarios
3. Data quality results



What strategies do you employ after go-live?

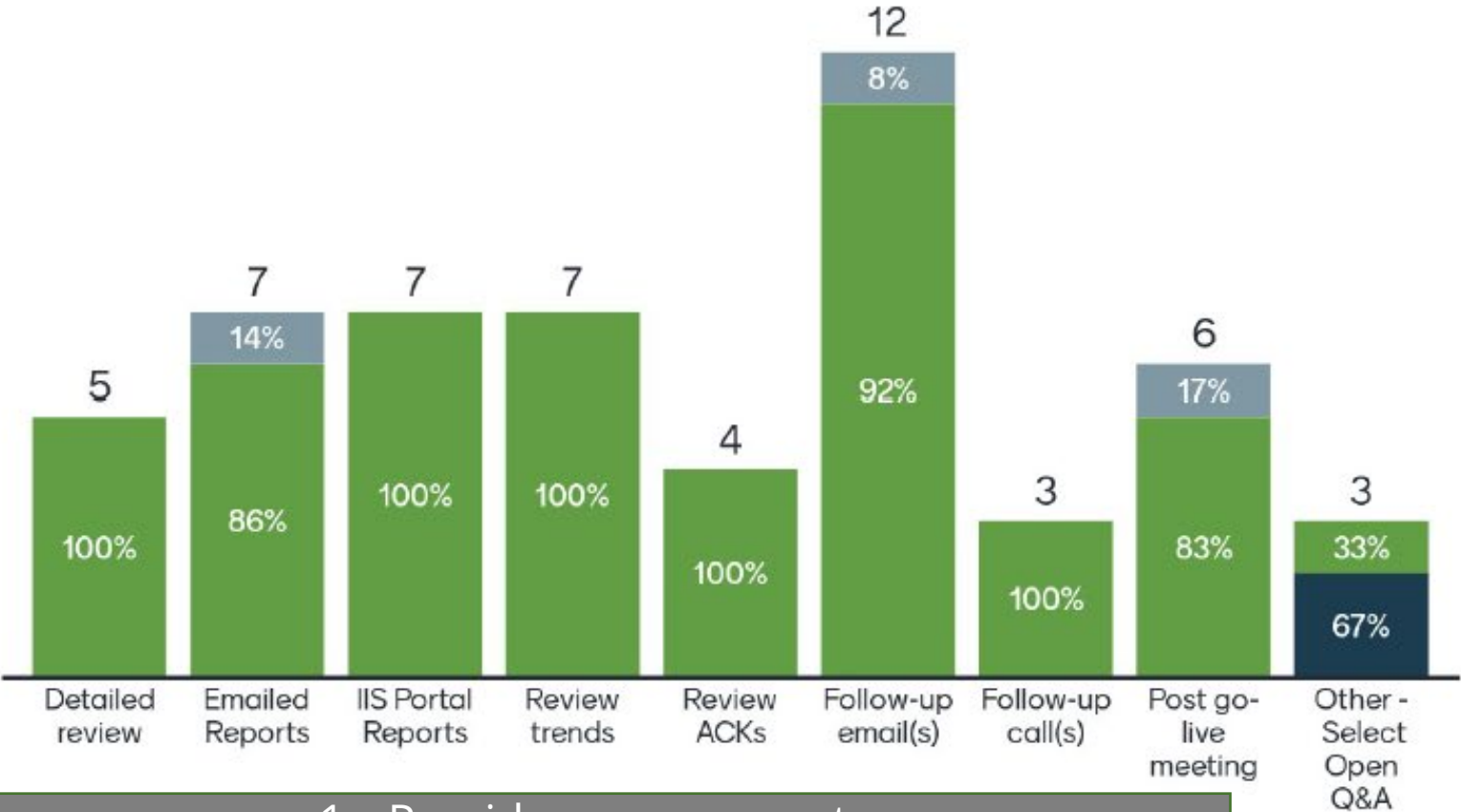

What perspective do you offer?

- Other
- Public Health, IIS, IIS Vendor
- Unknown

1. Provider engagement
2. Ongoing data validation
3. No ongoing validation
4. Inquiry from issues identified in reconciliation reviews
5. Sample review of messages and IIS records.

Go-live & Beyond



Suggestions

- Make resources highly visible and public-facing
- Provide IIS operating status
- Fast track future interfaces
 - Hubs adding provider organizations
 - Provider organizations adding clinics
 - Pilot / beta facilities



Suggestions Continued

- Review and implement AIRA and IIP best practice resources (see next few slides)
- Allow independent testing
 - Self-service
 - Without a particular provider



What additional thoughts do you want to share with EHRs?



EHR should ask about product or system the IIS use. Should help narrow down possible differences.

We have a burden to verify data completeness and quality - not just connectivity and message structure

With the increase in requests for immunization history for COVID. Is your EHR requesting only the vaccine history or history and forecasting? If forecasting are you using it for CDS?

Making sure providers are able to and know how to run a report of doses administered

Respond to your customers in a timely manner.

Provide your clients a DQA report of their acks and errors so they can own their data quality.

Thank you! Guides for deltas are wonderful for EHRs and IIS's

Provide training from start to finish to providers that pertains data quality and error resolution

EHRs want a point person but IIS turnover rate is high so that's not realistic

Resources



Onboarding
Consensus-Based
Recommendations

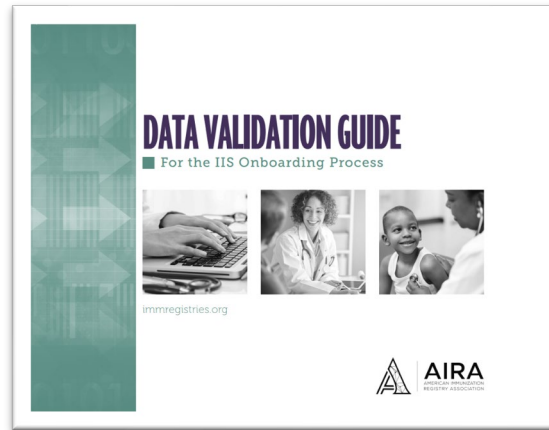

Data Validation Guide
for the IIS Onboarding
Process



Aggregate
Immunization
Acknowledgment
Message Reports
Guidance White Paper

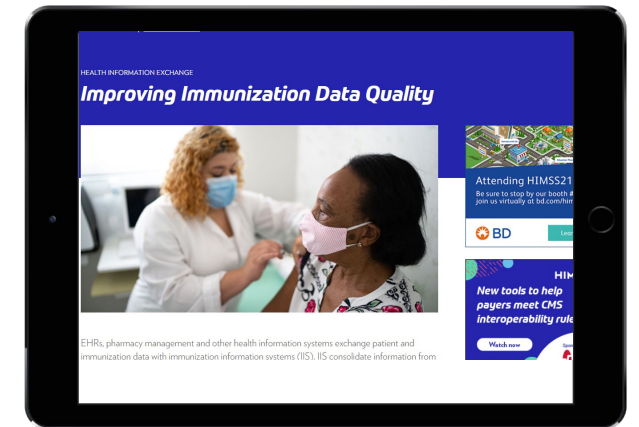

Improving Immunization
Data Quality

Resources

- Review and implement best practices:
 - AIRA's Onboarding Consensus-Based Recommendations
 - Webinar: <https://repository.immregistries.org/resource/introduction-to-onboarding-consensus-based-recommendations/>
 - Guide: <https://repository.immregistries.org/resource/onboarding-consensus-based-recommendations/>
 - AIRA's Data Validation Guide for the IIS Onboarding Process:
<https://repository.immregistries.org/resource/data-validation-guide-for-the-iis-onboarding-process/>
 - IIP's ACK Extracting and Aggregate Reporting
 - For Decision Makers: <https://www.himss.org/resources/improving-immunization-data-quality>
 - For Wonks: <https://www.himss.org/resources/aggregate-immunization-acknowledgment-message-reports-guidance-white-paper>



Thank you!

Connect with the IIP!

- IIP@himss.org
- himss.org/what-we-do-initiatives/immunization-integration-program
- Google "HIMSS IIP"
- Plenary Session Wednesday @ 2:15
- IIP: Improving Interoperability Through Cross-Sector Collaboration